



## Accessories for wireless receivers and repeaters RF built-in antenna SMA G-ST 2.5 m - NET Material number: 1479733

### Features/Options:

- RF built-in antenna with straight SMA connector plug
- Suitable for SW868 and SW922

### Dimensions

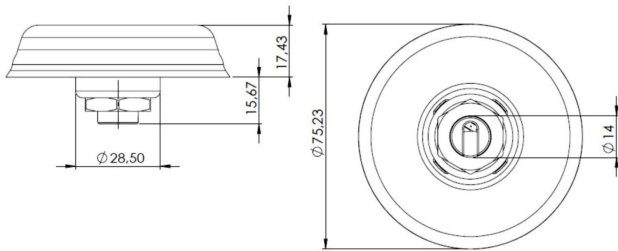

### Technical data

Cover	ABS, black
Sealing	TPE
Degree of protection	IP 67 to IEC/EN 60529
Connection	cable
Cable	RG174
Cable length	2.5 m
Connector	SMA (male)
Dimensions	77.4 x 15.9 mm (dimensions after mounting)
Ambient temperature	-40 °C ... +85 °C
Frequency range	824 - 960 MHz 1.8 GHz / 1.9 GHz 2.1 GHz / 2.4 GHz
Impedance	50 Ω
Polarization	linear
Gain	2.2 dBi
VSWR	<2.6:1
Note	Antenna gain depends on size of the metal plate. Stated SWR refers to a measurement of 2.5 m RG174 on 50x50 cm metal plate.



Accessories for wireless receivers and repeaters  
RF built-in antenna SMA G-ST 2.5 m - NET  
Material number: 1479733

Arrangement of receiver and switch antenna

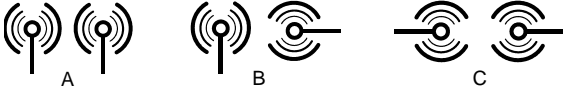

- A = Optimum mounting
- B = Possible mounting
- C = Unsuitable mounting