



## Accessories for wireless receivers and repeaters RF built-in antenna R-SMA G-ST 1 m - NET Material number: 1276080

### Features/Options:

- RF built-in antenna with straight RSMA connector plug
- Suitable for SW915 and SW917

### Dimensions

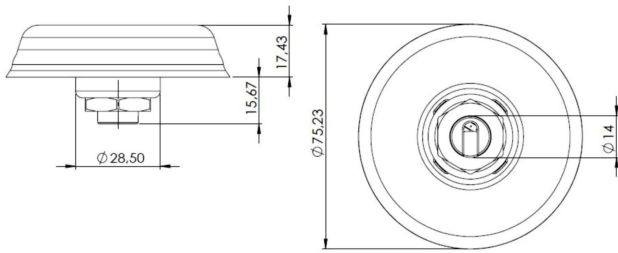

### Technical data

|                      |  |
|----------------------|--|
| Cover                | ABS, black   |
| Sealing              | TPE  |
| Degree of protection | IP 67 to IEC/EN 60529  |
| Connection           | cable  |
| Cable                | RG174  |
| Cable length         | 1 m  |
| Connector            | R-SMA (male)   |
| Dimensions           | 77.4 x 15.9 mm<br>(dimensions after mounting)  |
| Ambient temperature  | -40 °C ... +85 °C  |
| Frequency range      | 824 - 960 MHz<br>1.8 GHz / 1.9 GHz<br>2.1 GHz / 2.4 GHz  |
| Impedance            | 50 Ω   |
| Polarization         | linear   |
| Gain                 | 2.2 dBi  |
| VSWR                 | <2.6:1   |
| Note                 | Antenna gain depends on size of the metal plate.<br>Stated SWR refers to a measurement of 2.5 m RG174 on 50x50 cm metal plate. |



Accessories for wireless receivers and repeaters  
RF built-in antenna R-SMA G-ST 1 m - NET  
Material number: 1276080

Arrangement of receiver and switch antenna



- A = Optimum mounting
- B = Possible mounting
- C = Unsuitable mounting